

To achieve the industry’s highest reliability, Rexnord has designed 2¼-inch pitch Fortrex™ stainless steel MatTop chain, a breakthrough in tunnel pasteurizing conveying. In pasteurization, long-lasting shelf life and chain life are critically important. Long-lasting shelf life preserves the good taste and quality of beverages and foods. And, long-lasting chain life guarantees uninterrupted productivity as containers move at precise speeds through controlled temperature zones of long pasteurizer tunnels.

Features

- Stainless steel chain design ensures ultimate reliability at reduced total cost of ownership, including glass handling applications.
- Suitable for parallel and chevron stainless steel wearstrips, so significantly reduced retrofit cost.
- Chain rollers reduce tension by 60% over sliding belts and reduce motor power requirements.
- Split sprockets and idlers can accommodate a classic drive shaft construction.
- Superior, extended chain life.
- Elimination of unscheduled tunnel pasteurizer downtime.
- User-friendly riveted-pin retention system eliminates the need for welding during assembly.
- Maximum chain width is 6 meters.
- Maximum conveyor length is 43 meters.
- Open area is 50%.

Programme	
9217	Equipped with rollers every 3", suitable to run on chevron wearstrips
9227	Equipped with rollers every 6", to run parallel wearstrips spaced at 6"
Positrack	Tracking guides for optimum reliability throughout the length of the pasteurizer tunnel.
Fingerplates	Smooth product transfers at infeed and outfeed with self-clearing DTS®-C.



Fortrex 9227 belt in a food tunnel pasteurizer

Fortrex 9200

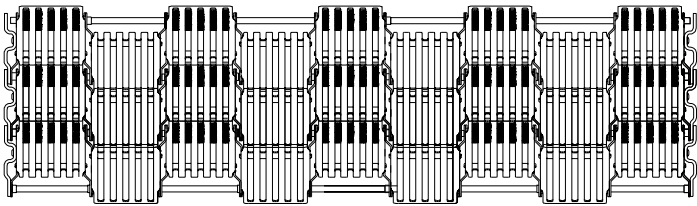
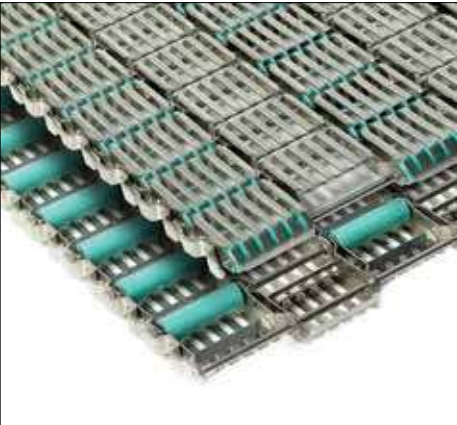

Assembly	Belt Type	Code Number*	Temperature range °C		Produt Load (max.)	Weight	Backflex Radius (min.)
			Dry	Wet	kg/m²	kg/m²	mm
Fortrex 9217							
Standard	9217	820.05.xx	4 to 100	4 to100	285	24.5	80
Positrack	9217 PT	820.06.xx					
Fortrex 9227							
Standard	9227	820.02.xx	4 to 100	4 to 100	285	24.0	80
Positrack	9227 PT	820.04.xx					

* In code numbers xx corresponds with the belt width (A), starting with 29 for 90, 30 for 93", and so on in steps of 3", up to 240"; see also page 208. For actual width please add 0.75" to nominal width.



Fortrex 9217

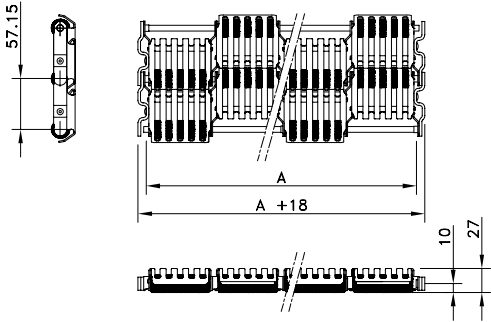

Fortrex 9227

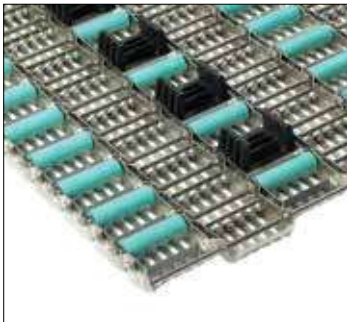
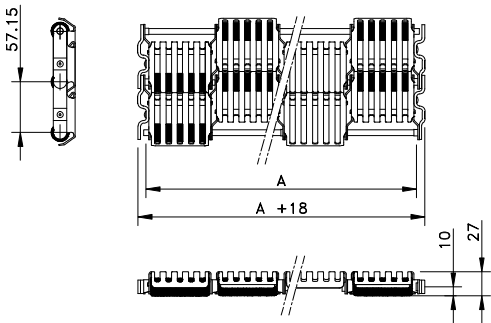

Positrack in the center of the belt or 1.5" Offset, depending on the width

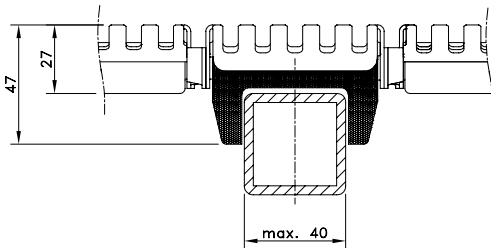

Classic Fingerplate

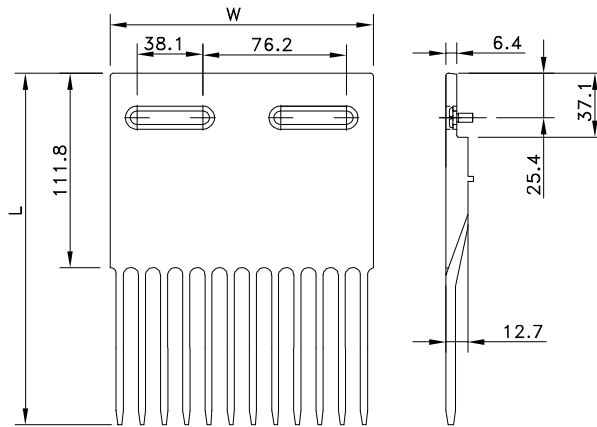

Comb fingerplate with M6 screw and caps	Code Number	Length L	Width W	Weight
		mm	mm	kg
Reinforced Polyamid				
Comb 5997/Fortrex	I5997/631183	202	150.6	0.2

* Combs are supplied with 2 * M6 Stainless Steel screws and 2 caps

Split Sprockets

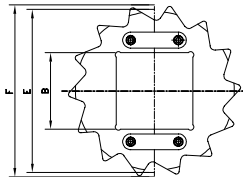

Split Idler Drums

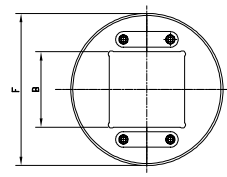

Sprocket Type	Code Number	Number of Teeth	Bore	Pitch Diameter E	Outside Diameter F	Hub Width A
			B mm/inch	mm	mm	mm
Split Sprockets						
Square Bores						
KUS 9200 T14 S120	820.10.00	14	120 mm	256.8	270.8	50.8
KUS 9200 T14 S3.5	820.10.04	14	3.5"			
Round Bores						
KUS 9200 T14 R90	820.10.02	14	90 mm	256.8	270.8	50.8
Split Idler Drums						
Square Bores						
KSXTS 9200 T14 S120	820.10.01	14	120 mm	256.8	236.0	50.8
KSXTS 9200 T14 S3.5	820.10.05	14	3.5"			
Round Bores						
KSXT 9200 T14 R90	820.10.03	14	90 mm	256.8	236.0	50.8
KSXT 9200 T14 R3.5	820.10.06	14	3.5"			

* Other bore sizes available upon request