

The 3120-Series 3-inch pitch belt is Rexnord strongest plastic MatTop chain, primarily used for industrial-type applications including oil-change conveyors, 2 lane final assembly line conveyors, Skid and pallet handling conveyors, 2-lane water test conveyors and automotive parts handling. The chain has proven itself also in single lane car wash and single lane end-of-line inspection conveyors replacing conventional technology. It is moulded in high performance acetal and utilizes Twist-Lock® plugs as well as ½" diameter polyester or stainless steel pins. The chain is available with several accessories like T1-inch and T2-inch automotive pushers and sideguards, all meeting the DIN24446 standard. The pushers are designed to be driven over and ensure a controlled handling of any size vehicles on top of the chain. This bricked chain is available from 4-inch wide with increments of 2-inch. Sprockets are available in solid or split execution and in several materials in robust design to handle increased loads.

Features

- Ultra high load capacity of 115,000 N/m (strongest plastic MatTop chain available). No need for (stainless) steel pins to reach maximum working load reducing overall chain weight and power consumption.
- Equally divided hinges combination with large ½" pin diameter provide very high stiffness.
- Long life design due to large pin diameter, optimum hinge eye width and proven wear resistant design of the chain underside (large contact surface).
- Easy installation and maintenance in combination with Twist-Lock pin retention at both sides, which are easy to operate with just a screwdriver and prevent the loss of plugs; self-closing under influence of chain weight.
- Superior drive technology also under high load and heavy duty circumstances, due to specific belt pocket and sprocket design.
- High strength pushers available intended for automotive and industrial usage.
- Available in SolidTop (3125), SafetyTop (3129) and RubberTop 3125 surface execution to meet any application conditions requirement.
- Standard available in BSM and in BYSM with yellow sides for clear moving belt edge safety indication; upon request also available with other color sides.
- High strength DIN style Automotive T1-inch and T2-inch pushers and H40-mm Sideguards available intended for automotive and industrial usage (sideguards are available exclusively through selected industry channels). Pushers and sideguards both meet the requirements of the DIN24446 standard.
- Belt can be equipped with T1 or T2 automotive pushers and or sideguards, please indicate pushers with T1 or T2 followed by the spacing of the pushers (e.g T18P means every 18th row). Indicate sideguard with SG40. Side indent to the pusher is minimum ½" with 2" increments.
- Chain is standard equipped with Polyester (PBT) pins. On request the chain can be equipped with stainless steel pins and in other chain materials as well.

Programme	
3125 Solid Top	Close Surface, suitable for any kind of industrial and automotive application
3129 SafetyTop	Closed non-skid surface; prevents slipping in wet, greasy or humid environments.
Belt accessories	T2-inch pushers available. Robust pushers designed to be driven over by vehicles



Exterior carwash entry 3125 belt conveyor with t2 puchers



3125 End of line inspection belt conveyor with t2 din pushers

Solid Top 3125

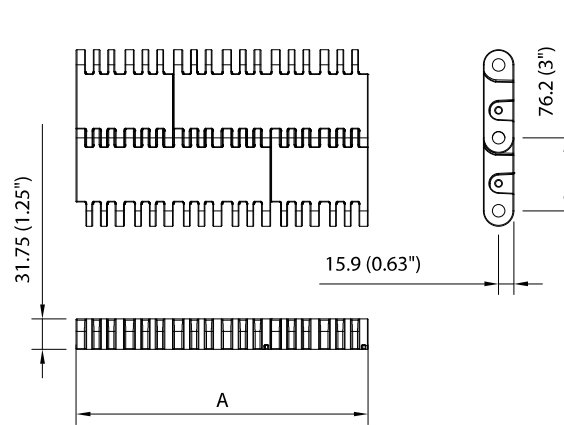
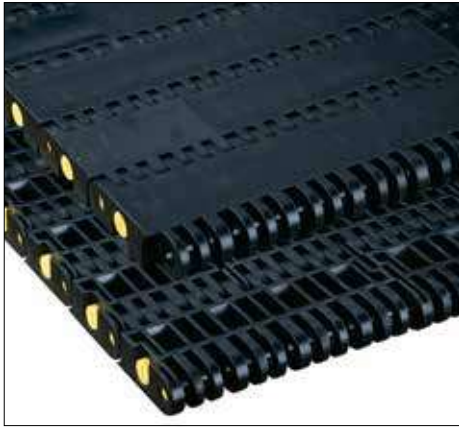

Assembly	Belt Type	Code Number*	Temperature range °C		Working Load (max.)	Weight	Backflex Radius (min.)
			Dry	Wet			
					N/m (21°C)	kg/m ²	mm
Acetal With Polyester Pins							
Standard	BSM 3125	I3125BSMKxx	-30 to +80	up to 65	115000	31.10	76.2
Standard	BYSM 3125	I3125BYSMK					
Standard	BSM 3125 K4	I3125BSMK004			115000	31.10	

Safetytop 3129

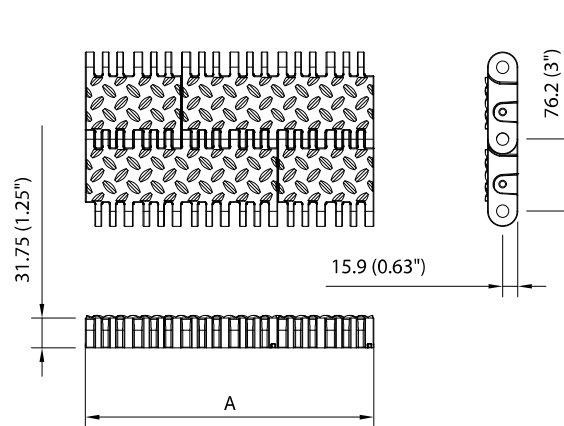

Assembly	Belt Type	Code Number*	Temperature range °C		Working Load (max.)	Weight	Backflex Radius (min.)
			Dry	Wet			
					N/m (21°C)	kg/m ²	mm
Acetal With Polyester Pins							
Standard	BSM 3129	I3129BSMKxx	-30 to +80	up to 65	115000	31.10	76.2
Standard	BYSM 3129	I3129BYSMKxx					

* In code numbers xx correspond with the belt width (A). Standard width of these belts begin at 4" with 2" increments up to 190"; 4" and 8" execution are mold-to-width executions. See page 208.

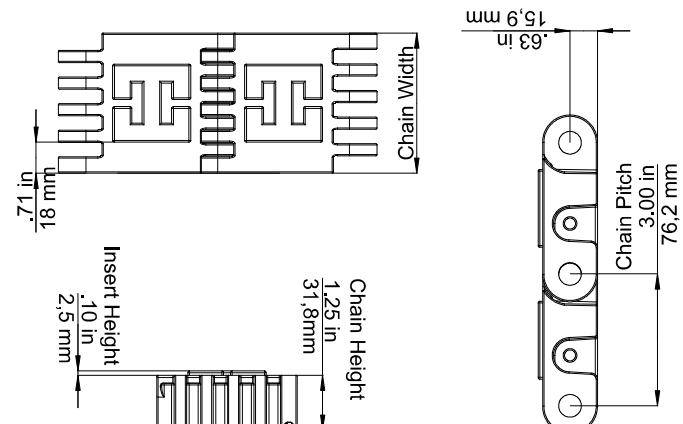

BSM3125-K4 MTW execution

Rubber Top 3125

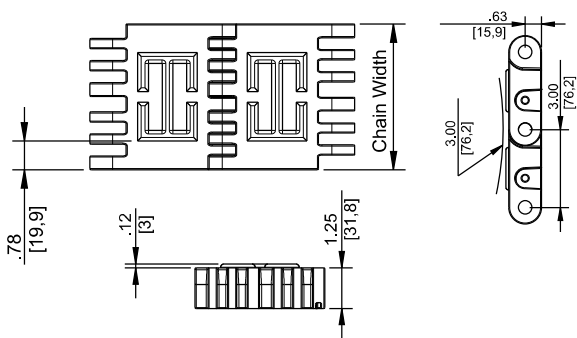

Assembly	Belt Type	Code Number*	Temperature range °C		Working Load (max.)	Weight	Backflex Radius (min.)
			Dry	Wet	N/m (21°C)	kg/m²	mm
Acetal With Polyester Pins							
Standard	BSM 3125 RT-K4 MTW	876.29.10	-30 to +80	up to 65	115000	31,10	76,2
Standard	BSM 3185 RT-K3.2 MTW	I3185BSM3.2 -30	-30 to +80	up to 65	115000	31,10	76,2

Classic Sprockets

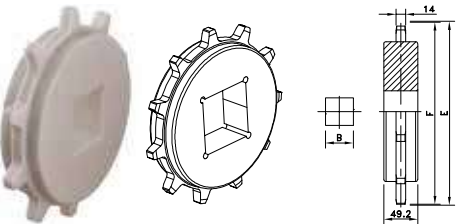

Split Sprockets

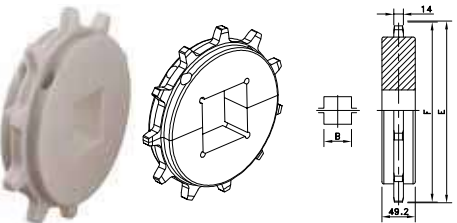

H-Style Sprockets

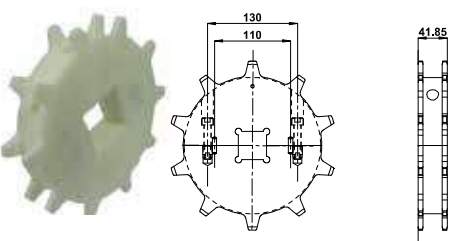

Sprocket Type	Code Number	Number of Teeth	Bore	Pitch Diameter E	Outside Diameter F	Hub Width A	
			B				
			mm	mm	mm	mm	
Classic Sprocket							
Square Bore							
KU 3120 T09 S60	114-5171-8	9	60	222.8	218.9	47.8	
KU 3120 T09 S90	114-5171-14	9	90				
KU 3120 T10 S60	114-5172-8	10	60	246.6	244.1		
KU 3120 T10 S90	114-5172-14	10	90				
KU 3120 T11 S60	114-5173-8	11	60	270.5	269.1		
KU 3120 T11 S90	114-5173-14	11	90				
Split Sprockets							
Square Bore							
KUS 3120 T09 S60	614-731-3	9	60	222.8	218.9	47.8	
KUS 3120 T09 S90	614-731-9	9	90				
KUS 3120 T10 S60	614-732-3	10	60	246.6	244.1		
KUS 3120 T10 S90	614-732-9	10	90				
KUS 3120 T11 S60	614-733-3	11	60	270.5	269.1		
KUS 3120 T11 S90	614-733-9	11	90				
H-Style 3180 Sprockets							
Square Bore							
KU 3180 T08 S60	890.65.59	8	60	199	193.5	42	
KU 3180 T09 S60	890.66.59	9	90	223	218.9		
KU 3120 T10 S60	890.67.59	10	60	246	244.1		
KU 3120 T11 S60	890.68.59	11	90	270	269.1		

Other bores sizes (square and round) and number of teeth are available on request. Smallest possible sprocket has 8 teeth. Stainless steel sprockets available upon request.



Din style sideguard 3120

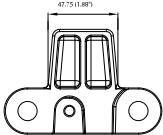

H40 dimensions

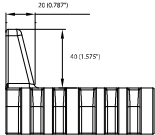

Din style pusher 3120

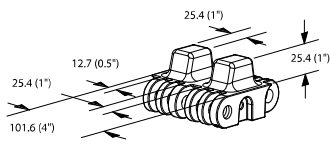

T1 dimensions

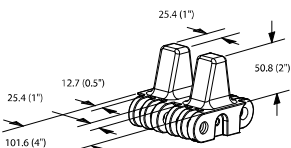

T2 dimensions