

## Part. S0768

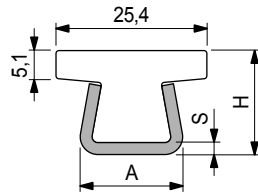

### Chain - guide profile



S	H	A
mm	mm	mm
1,5	17	16
2	17,5	17

Thickness S mm	Metal profile material	Length metres	Code	Weight kg/m
1,5	Austenitic stainless steel	3	609083N	0,63
		6	609093N	
2	Austenitic stainless steel	3	609113N	0,74
		6	609123N	

- Colour: white.
- Min. curvature radius: 160 mm.
- Linear expansion coefficient:  $4 \times 10^{-5} \text{ } ^\circ\text{C}^{-1}$ .
- Calculation of thermal expansion see Technical information.
- Packaging: 24 metres.

## Part. S0767



### Chain - guide profile

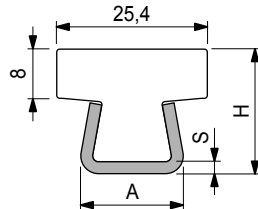

S	H	A
mm	mm	mm
1,5	20,5	16
2	21	17

Thickness S mm	Metal profile material	Length metres	Code	Weight kg/m
1,5	Austenitic stainless steel	3	609033N	0,72
		6	609043N	
2	Austenitic stainless steel	3	609063N	0,82
		6	609073N	

- Colour: white.
- Min. curvature radius: 160 mm.
- Linear expansion coefficient:  $4 \times 10^{-5} \text{ } ^\circ\text{C}^{-1}$ .
- Calculation of thermal expansion see Technical information.
- Packaging: 24 metres.

● Best Seller

● Standard

● On request: minimum quantity may apply. Consult our Customer Service for availability.

Item code for order = Part. + Code

- **Material:** Polyethylene UHMWPE with molecular density 5.600.000 g/mol.  
Characteristics: new material Polyethylene ULF™ brown red (UHMWPE): reduced friction coefficient, higher wear resistance.
- **Operating temperature White:**  
In air (- 40 to + 80 °C).  
In hot water (+ 70 °C).
- **Operating temperature ULF™ brown red:**  
In air (- 40 to + 45 °C).  
In hot water (+ 45 °C).
- **Polyethylene ULF™ is FDA approved**  
Polyethylene ULF™ complies with the Code of Federal Regulations Title 21, § 177.1520 "Olefin Polymers" of the Food and Drug Administration (FDA) of April 1, 2008.
- **Coefficient of friction between chain POM and wearstrip ULF™:** 0,08.  
Note: for calculation of chain pull refer to Technical Support.
- **Position of guides.** See Technical information.

### Deflection of Part. S0223 - S0310 - S0356

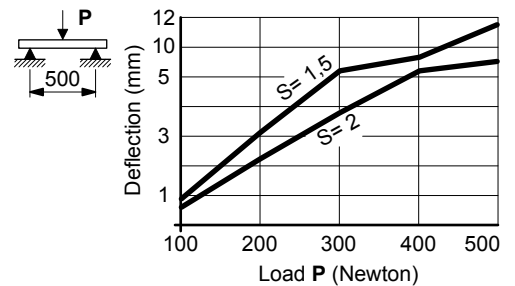

### TableTop® chains series 812 - 815 - 820 - 831 - 881TAB - 8811TAB - 879TAB - 880TAB

Chain width 82,5 mm (K 325) / Pitch 88 mm

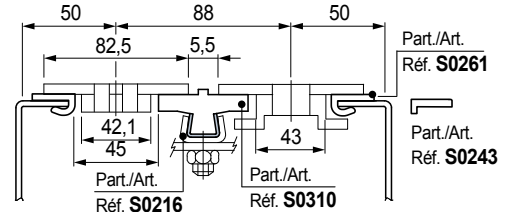

\*= Fixing clamp can be used only with chains 812-815-820-831

Chain width 82,5 mm (K 325) / Pitch 85 mm

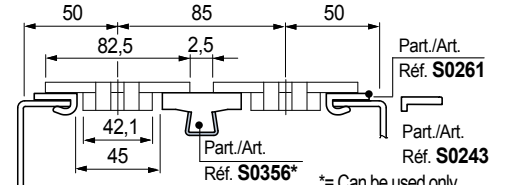

\*= Can be used only with chains 812-815-820-831

Chain width 82,5 mm (K 325) / Pitch 83,5 mm

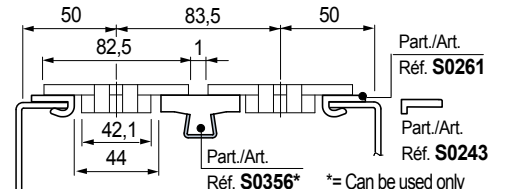

\*= Can be used only with chains 812-815-820-831