

for Part. S0223 - S0317 - S0219 - S0273 - S0393 - S0596 - S0308 - S0715 - S0765 - S0767 - S0768 - S0769 - S0770

Part. S0694

Guide-rail clamp



With two fixing screws

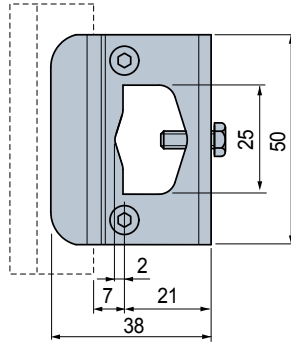
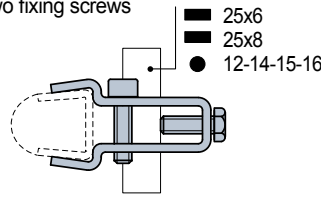

Code	Weight kg
689222	0,10

- Material: clamp and bolt in austenitic stainless steel.
- Packaging: 16 pieces.

Assembly of Part. S0694

Fixing on plates

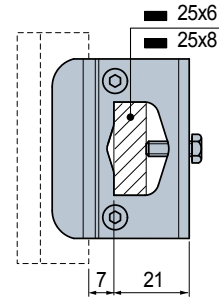

Fixing on rods

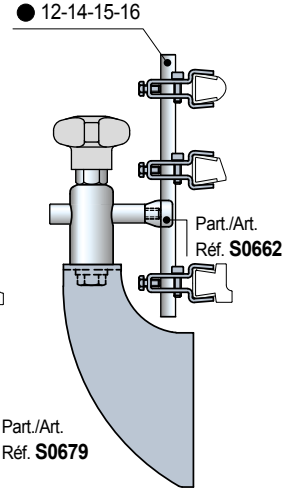
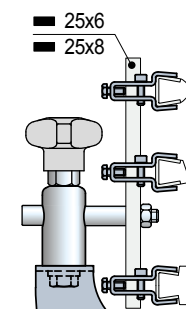
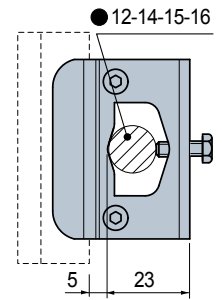

Part. S0217

Guide-rail clamp (double)

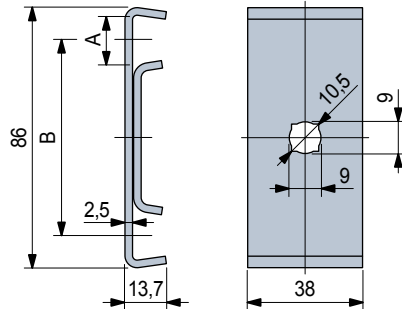

Use	A mm	B mm	Code	Weight kg
For guides with S = 1,5	16	64,5	60141	0,14
For guides with S = 2	17	63,5	695131	

- Material: austenitic stainless steel.
- Packaging: 50 pieces.
- Accessories: swivel pin connection Part. S0740 - S0740P.

Pin dimensions for Part. S0217

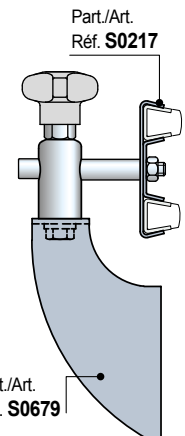
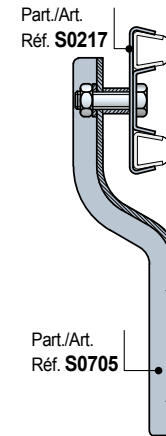
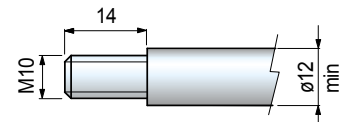

• **Swivel pin connection** of Part. S0740 - S0740P
Use for conveyors with (format change).
They allow an easy regulation of product-guides on corner tracks.

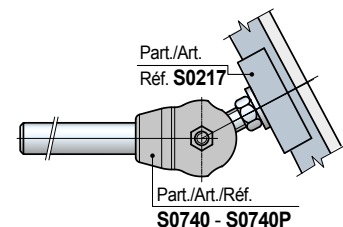

- **Best Seller**
- **Standard**
- **On request:** minimum quantity may apply. Consult our Customer Service for availability.

Item code for order = Part. + Code