

Guide - Rail Clamps

for Part. S0223 - S0219 - S0273

• **Assembly** of Part. S0736 - S0737 - S0738

The clamps allows the junction of straight tracks with corner tracks.
Ideal to adjust the length of side guides near the curves when width adjustment is needed.

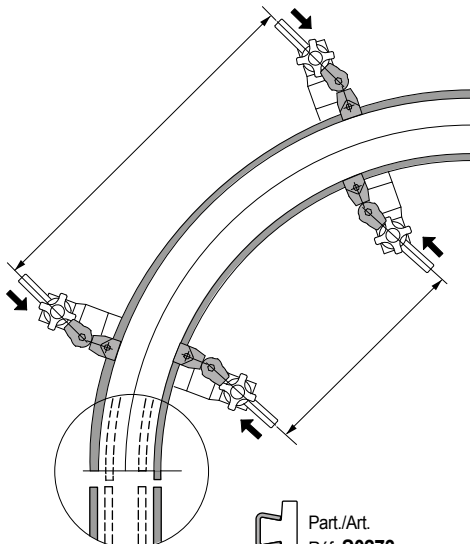

Part./Art.
Réf. **S0273**

Part./Art.
Réf. **S0223**

Part./Art.
Réf. **S0219**

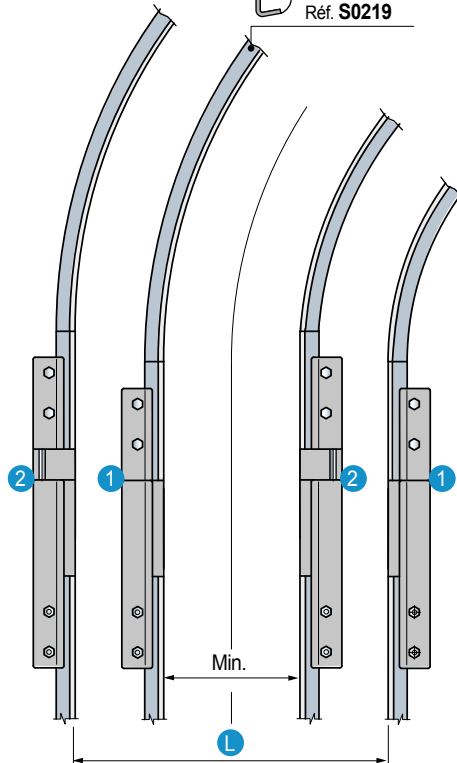

- 1 - Closed clamp.
- 2 - Open clamp.
- L - Size changing width.

■ **Sliding joint clamp**

Clamp fully closed

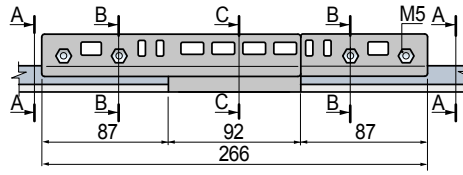

Clamp fully open

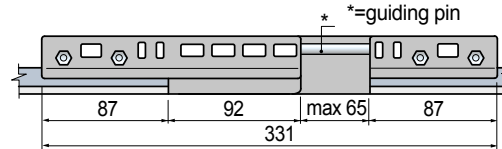

Part. S0736
Part. S0737
Part. S0738



■ **Part. S0736 - Sliding joint clamp for Part. S0219**

Part./Art.
Réf. **S0219-
S0219XLF**



Sez./Sec.
SeK. A-A

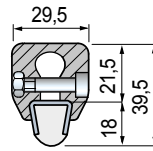

Sez./Sec.
SeK. B-B

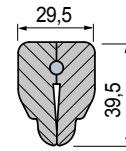

Sez./Sec.
SeK. C-C

■ **Part. S0738 - Sliding joint clamp for Part. S0223**

Part./Art.
Réf. **S0223**



Sez./Sec.
SeK. A-A

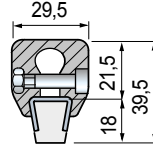

Sez./Sec.
SeK. B-B

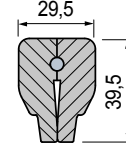

Sez./Sec.
SeK. C-C

■ **Part. S0737 - Sliding joint clamp for Part. S0273**

Part./Art.
Réf. **S0273**



Sez./Sec.
SeK. A-A

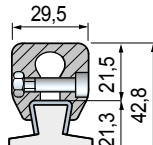

Sez./Sec.
SeK. B-B

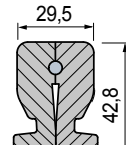

Sez./Sec.
SeK. C-C

Type of guides to joint	Code	Weight kg
Part. S0219 - S0219XLF	S0736695402	
Part. S0223	S0738695422	0,24
Part. S0273	S0737695412	

- Material: clamp in acetal (white).
Guiding pin in austenitic stainless steel.
Tightening bolt in austenitic stainless steel.
- Max recommended tightening torque: 0,4 Kgm.
- Packaging: 1 piece.

- **Best Seller**
- **Standard**
- **On request:** minimum quantity may apply.
Consult our Customer Service for availability.

Item code for order = Part. + Code